

DRAWING NUMBER

HT038 SERIES

REV.

-

REVISION

ECN	LTR	DESCRIPTION	DATE	APPROVED
---	B	REVISE AND REDRAW	6/97	BWT

MODEL	"A" DIM.	"B" DIM.	"C" DIM.
HT03800	.250(6.4)	.430(10.9)	1.013 (25.7)
HT03801	.650(16.6)	.830(21.1)	1.413 (35.9)
HT03802	1.050(26.7)	1.230(31.3)	1.813 (46.1)
HT03803	1.450(36.9)	1.630(41.4)	2.213 (56.2)
HT03804	1.850(47.0)	2.030(51.6)	2.613 (66.4)
HT03805	2.250(57.2)	2.430(61.8)	3.013 (76.5)

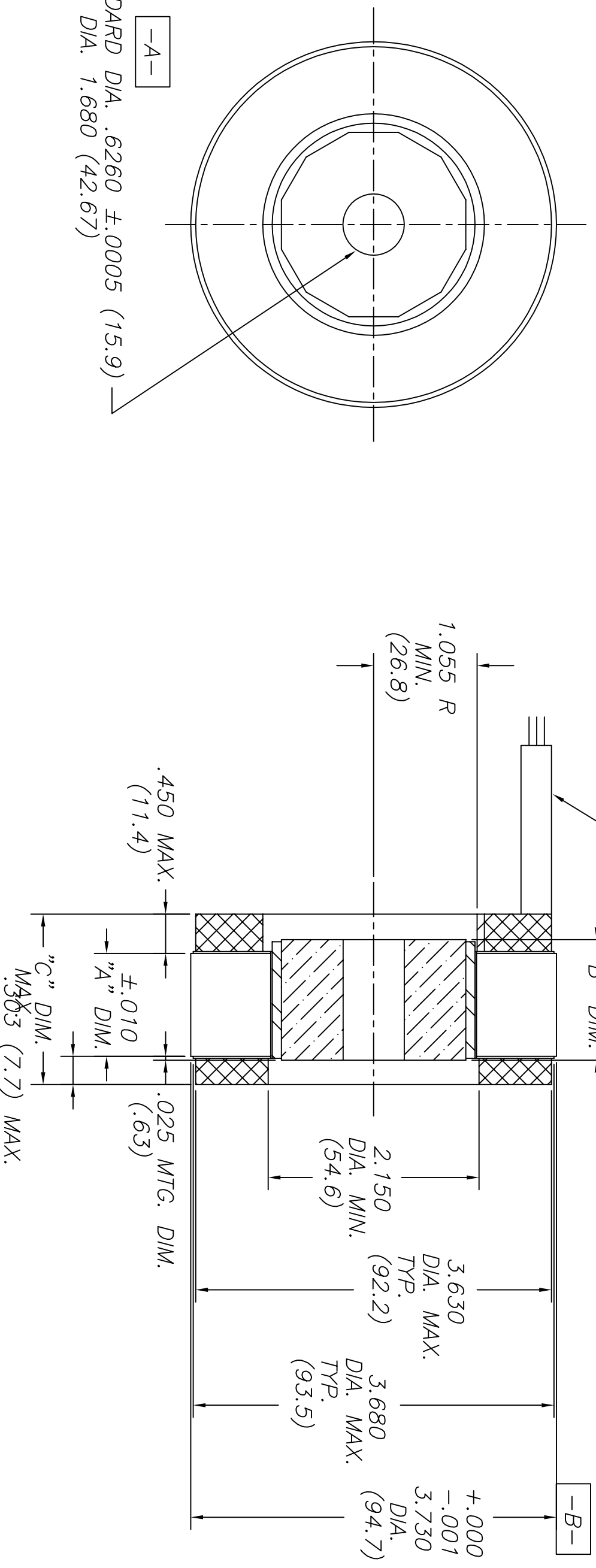

1. MOTOR SUPPLIED AS TWO SEPARATE COMPONENTS, ROTOR ASSEMBLY AND STATOR ASSEMBLY.
2. DIAMETERS "A" AND "B" TO BE CONCENTRIC WITHIN .002 WHEN MOUNTED.
3. MOUNTING SURFACE BETWEEN 3.730 AND 3.680 DIAMETERS ON BOTH SIDES.

UNLESS OTHERWISE SPECIFIED DIMENSIONS ARE IN INCHES TOLERANCES ON		DRAFTSMAN:	DATE:	 TULSA, OK 74146-3638, USA OUTLINE DRAWING FRAMELESS MOTOR	
ANGLES	3 PLACE	2 PLACE	06/97		
±0° 30'	DEC ± .005	DEC ± .01	CHECKER:		
MATERIAL		DO NOT SCALE	ENGINEER:		
FINISH		CUSTOMER:		DWG	CODE
				SIZE	IDENTIFICATION
				B	NUMBER
					3HINO4
					DRAWING NUMBER
					HT038 SERIES
				SCALE:	
					SHEET
					1 of 1